

# Naperville Downtown Streetscape

JEFFERSON | MAIN | JACKSON | WEBSTER

# Public Information Meeting

September 4, 2019

# W e l c o m e



# Proposed Project Schedule

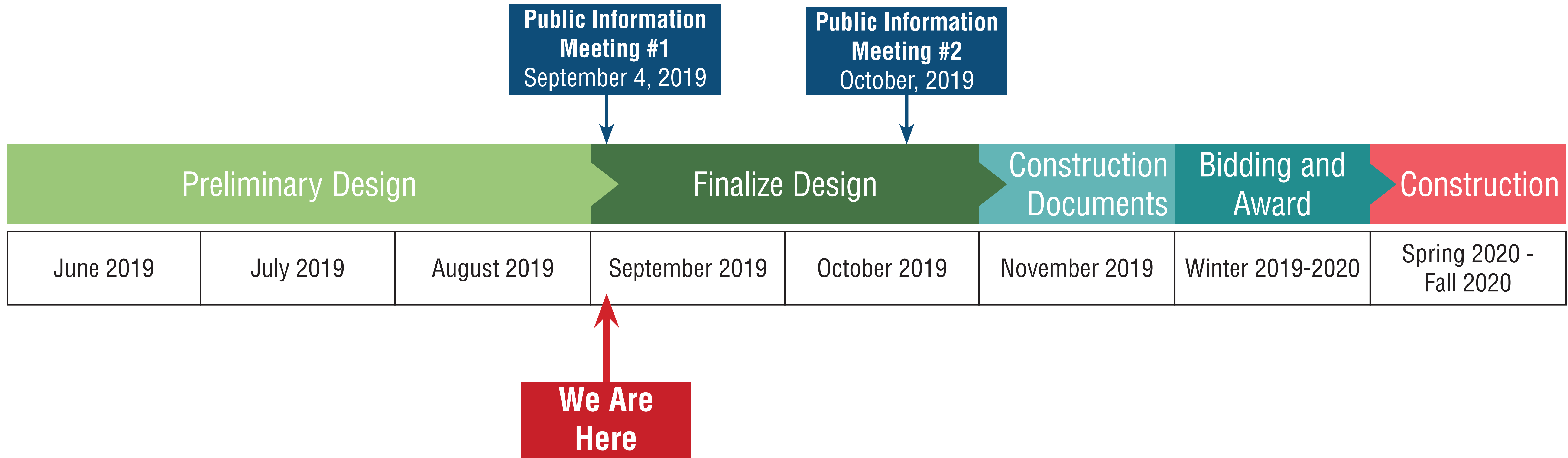



# Project Location



Limits of Streetscape Project



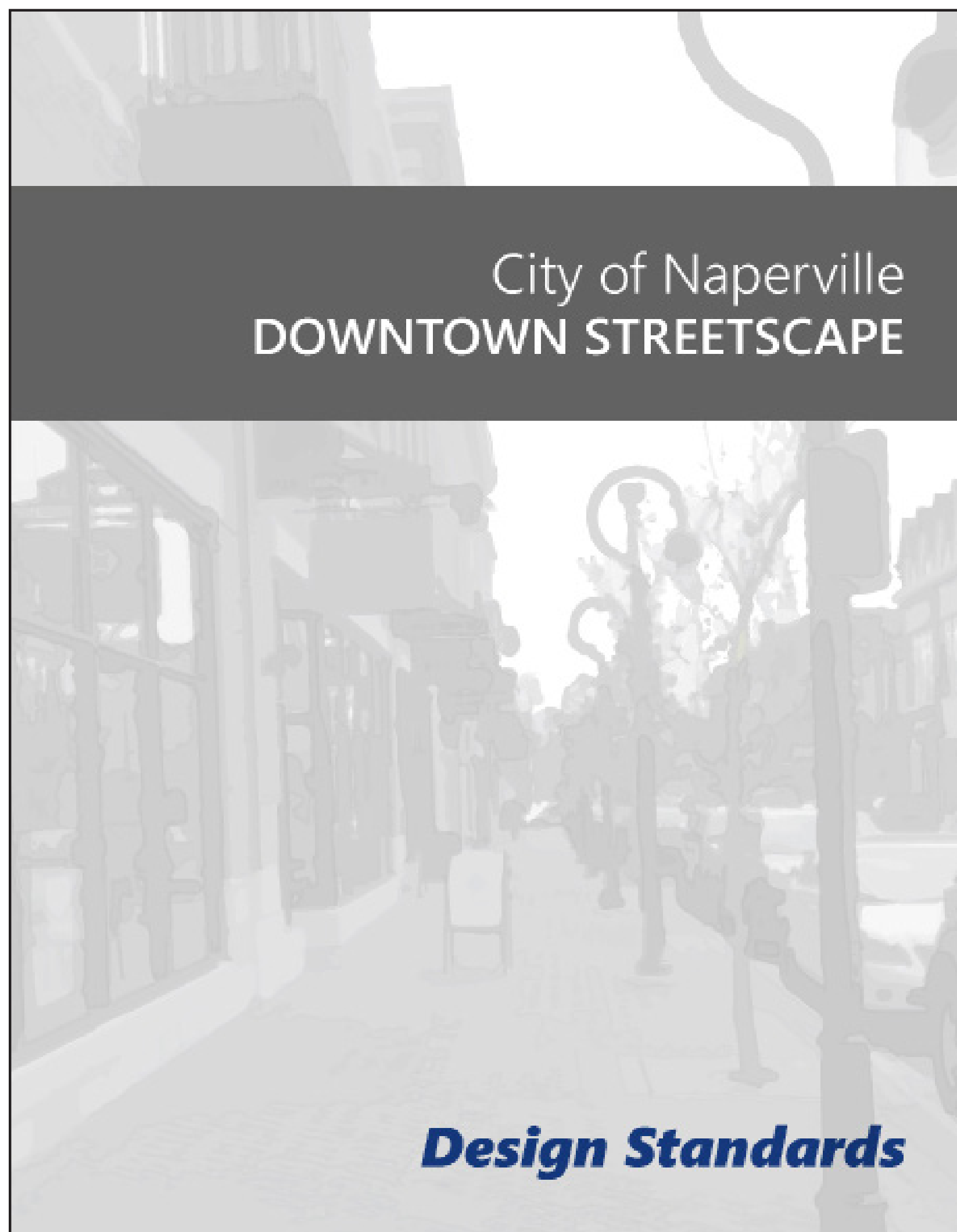

*Consultant Team:*



**P2C Designs LLC**  
43 East Jefferson Avenue  
Suite 201B  
Naperville, Illinois 60540



**Upland Design Ltd.**  
24042 West Lockport Street  
Suite 200  
Plainfield, Illinois 60544



**Urban GIS**  
1143 West Rundell Place  
Suite 301  
Chicago, Illinois 60607

*Downtown Streetscape Types Map*

**Legend**

- Downtowns - Narrow < 13.5'
- Downtowns - Base 13.5' to 15.5'
- Downtowns - Wide > 15.5'

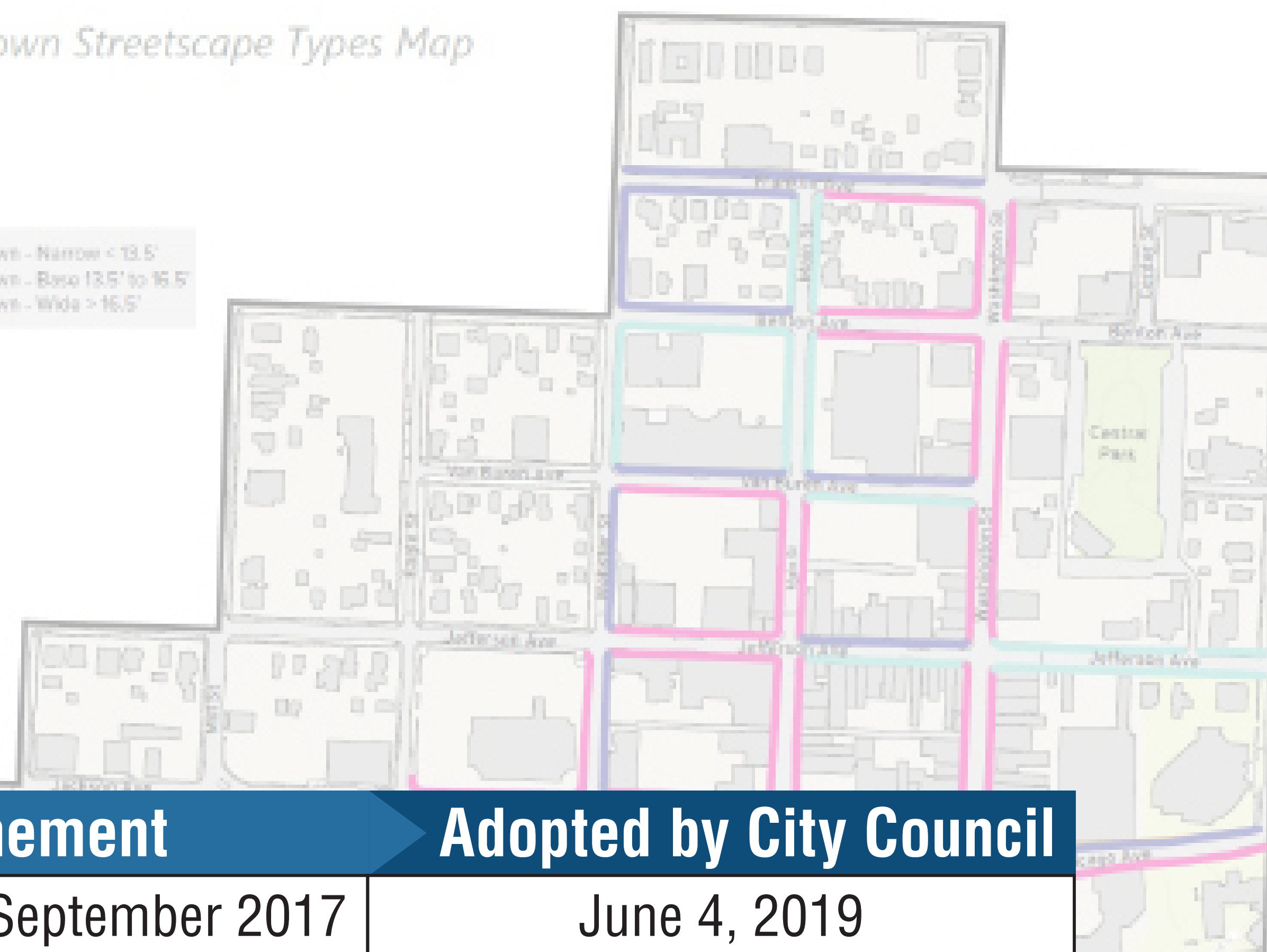

**Concept Design**

May 2016 – July 2016

**Standard Refinement**

September 2016 – September 2017

**Adopted by City Council**

June 4, 2019

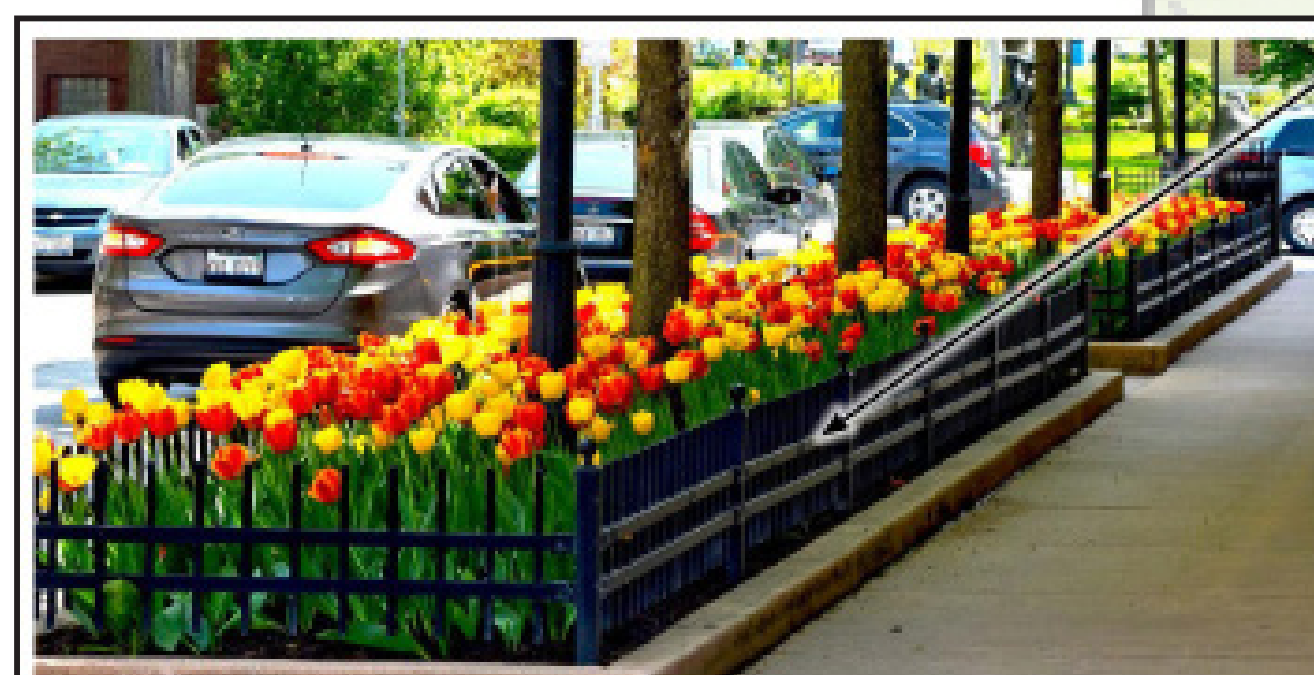
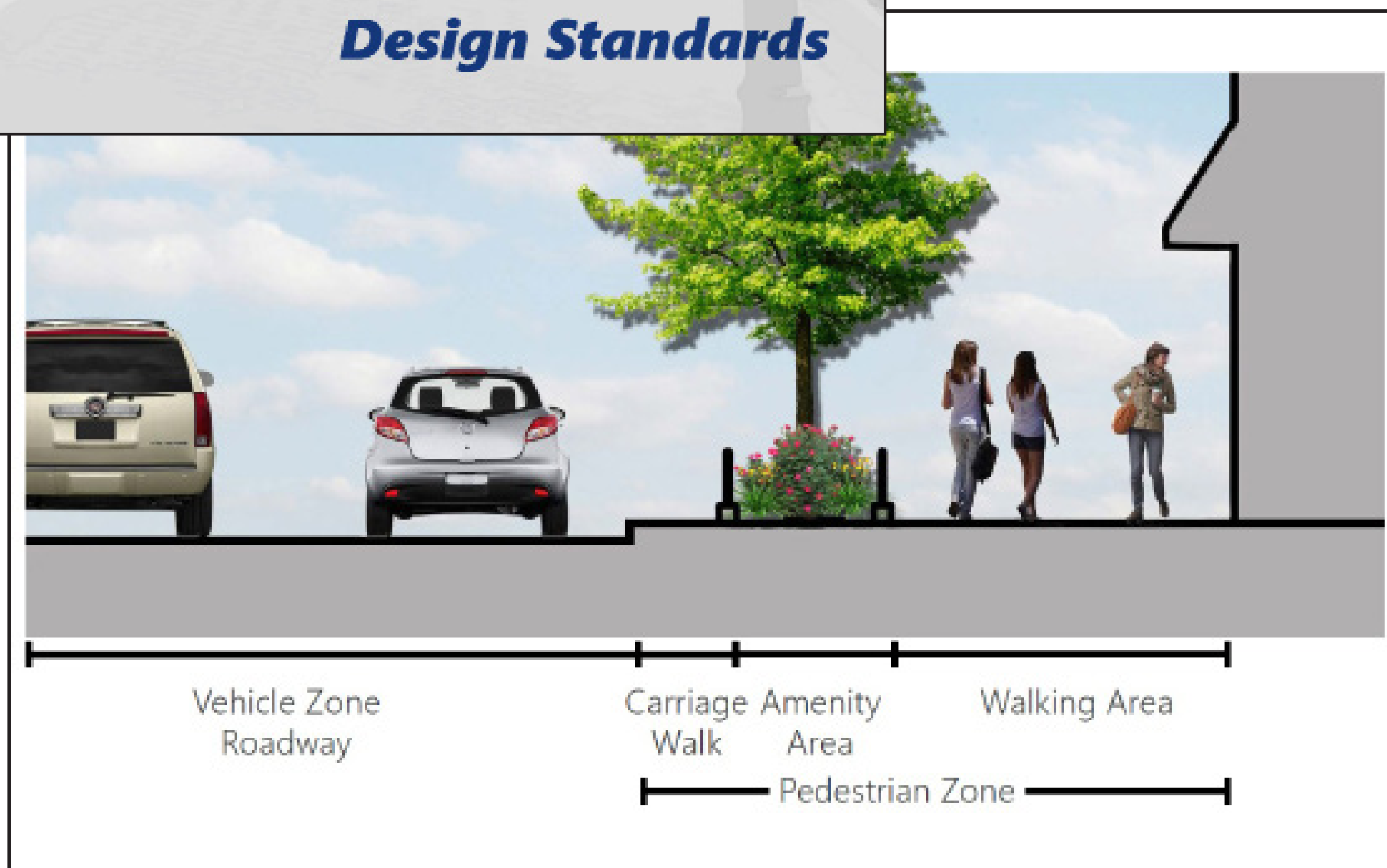

18" Tall Black Steel Planter Railing



Litter Receptacle



Recycle Receptacle



Bollard



Standard Bike Rack



Standard Bench - 6' to 8' length



Planter Pots



# Main Street Alternatives

### Most Trees

Trees	18
Parking Spaces	16
Sidewalk Width	6' min
Planter Area	1330 SF

With Brick Driveway Apron

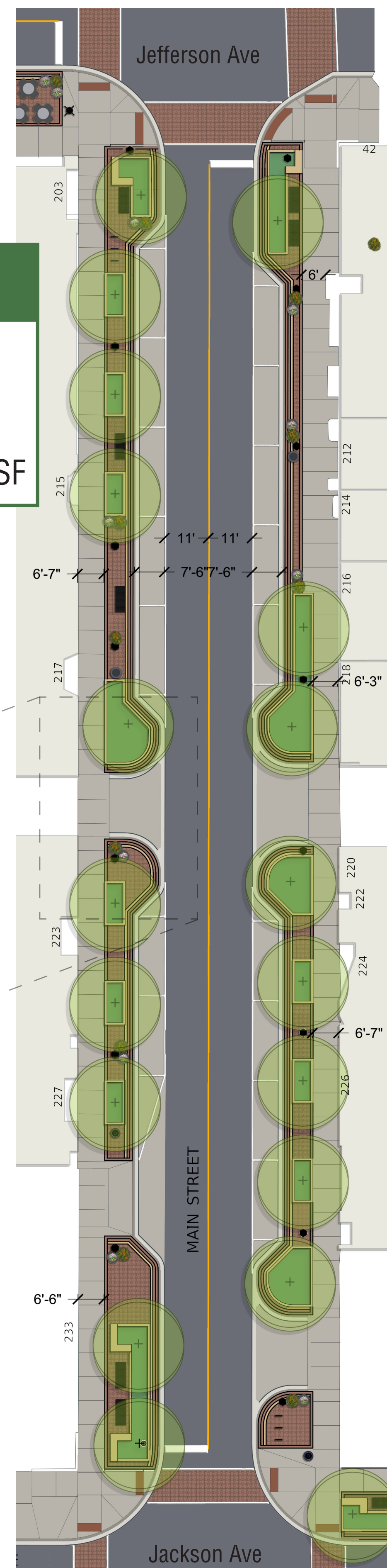

### Most Parking

Trees	16
Parking Spaces	19
Sidewalk Width	6' min
Planter Area	1070 SF

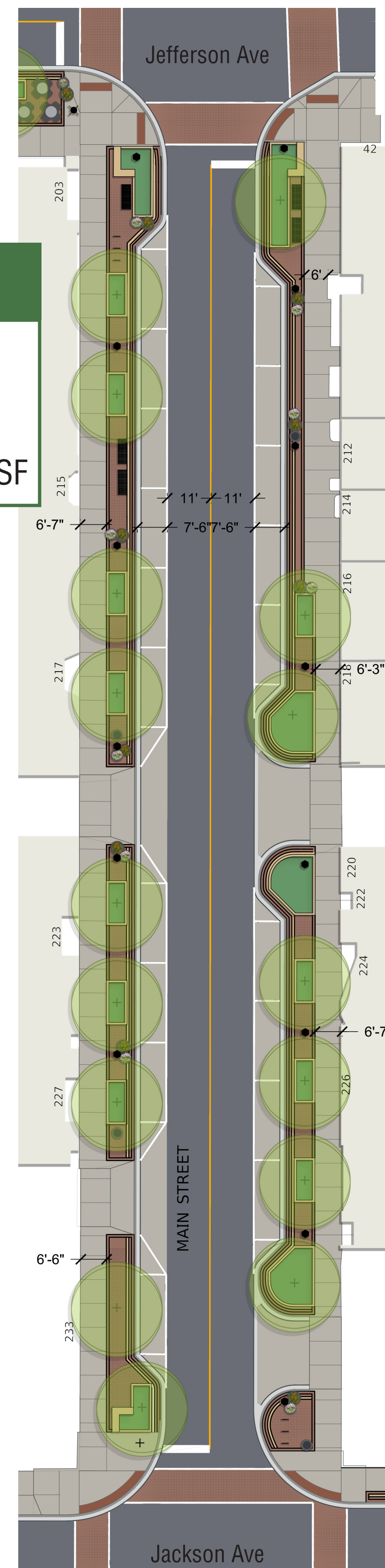

### Widest Sidewalk

Trees	9
Parking Spaces	16
Sidewalk Width	8' min
Planter Area	900 SF

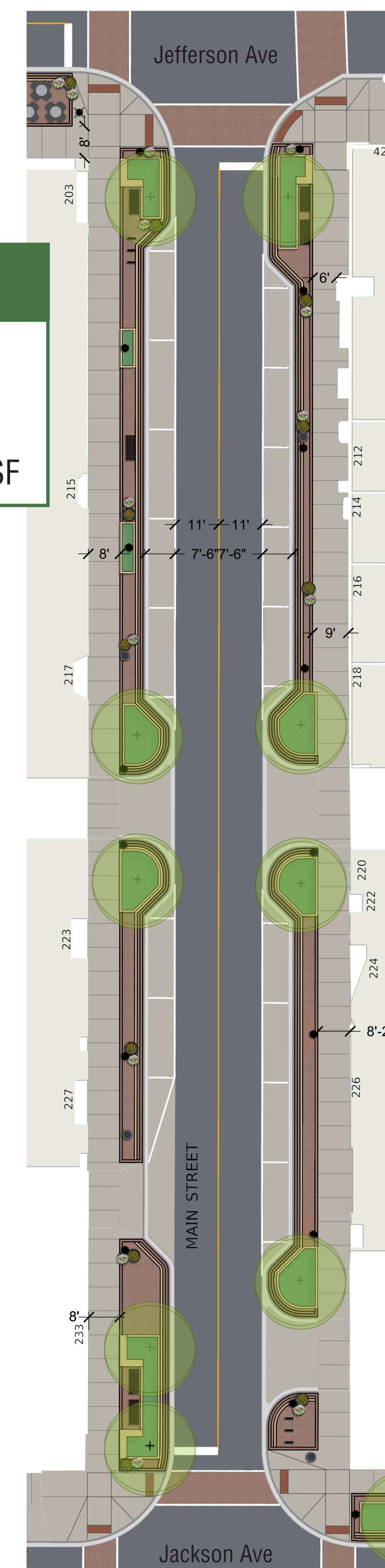





Most Trees	
Trees	10
Parking Spaces	11
Sidewalk Width	7'-7" min
Planter Area	475 SF

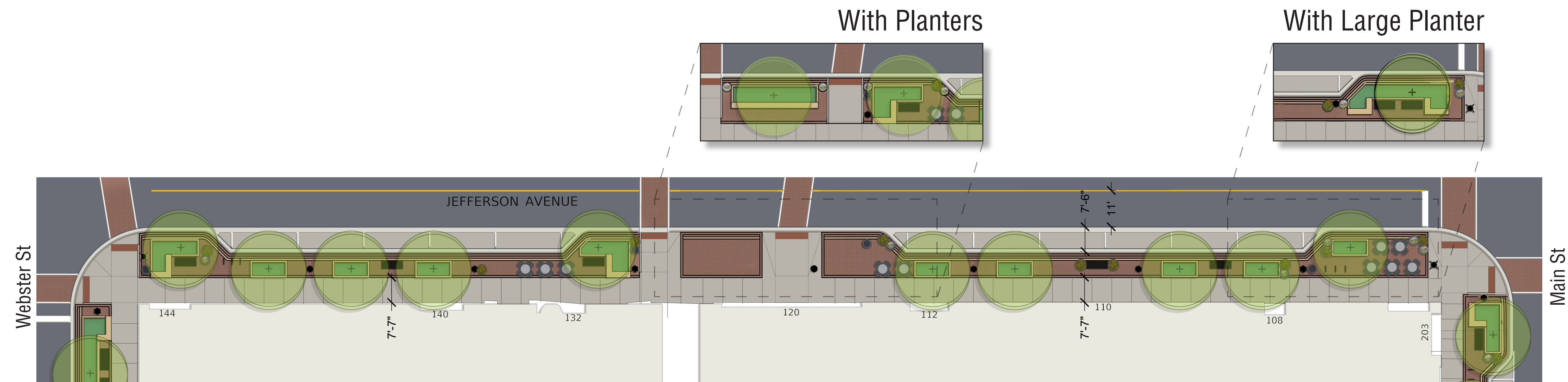

Most Parking	
Trees	9
Parking Spaces	12
Sidewalk Width	7'-7" min
Planter Area	510 SF

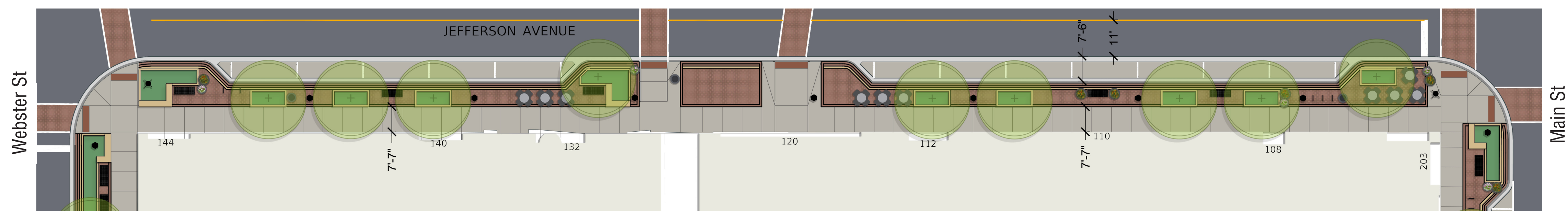

Widest Sidewalk	
Trees	3
Parking Spaces	11
Sidewalk Width	8' min
Planter Area	330 SF

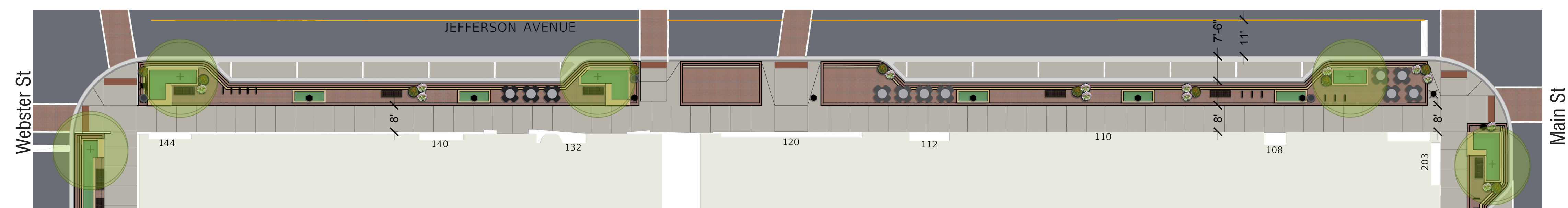





## Webster St

Most Trees	Most Parking	Widest Sidewalk
Trees 1 Sidewalk Width 8' min Planter Area 275 SF	Trees 1 Sidewalk Width 8' min Planter Area 275 SF	Trees 1 Sidewalk Width 10' min Planter Area 210 SF

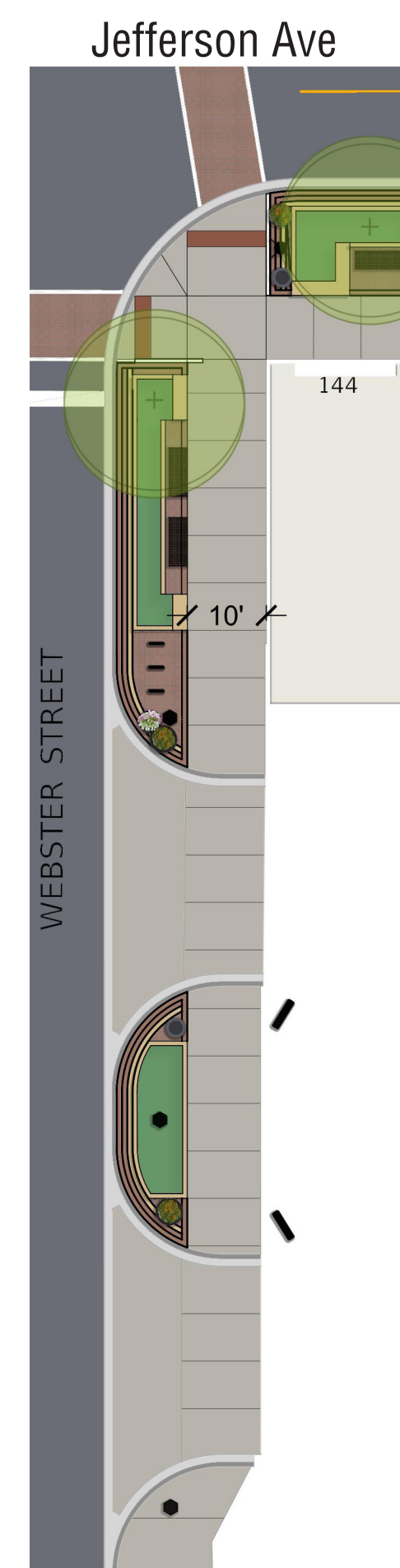
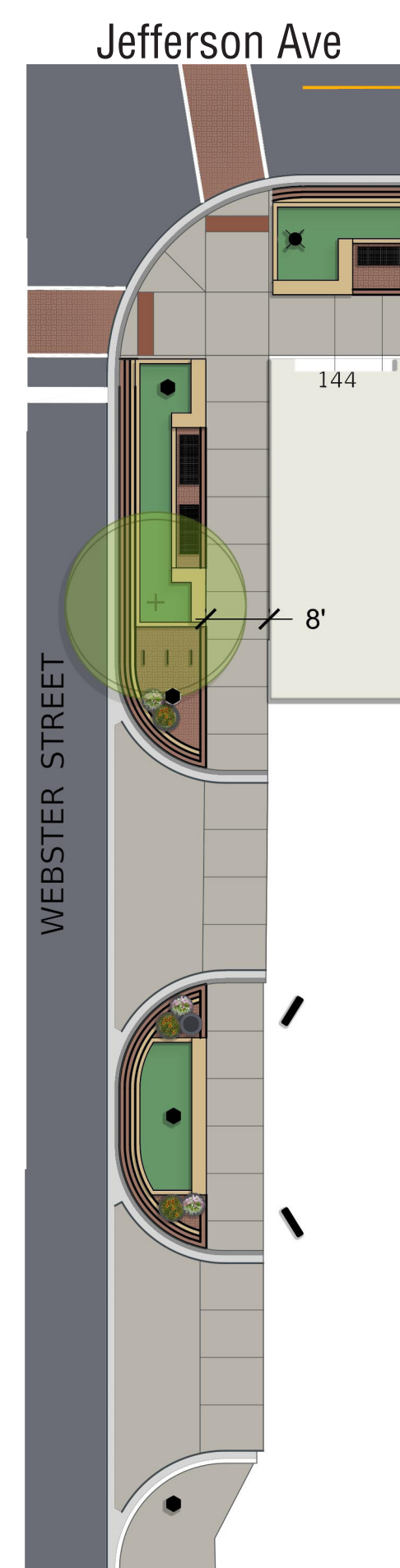
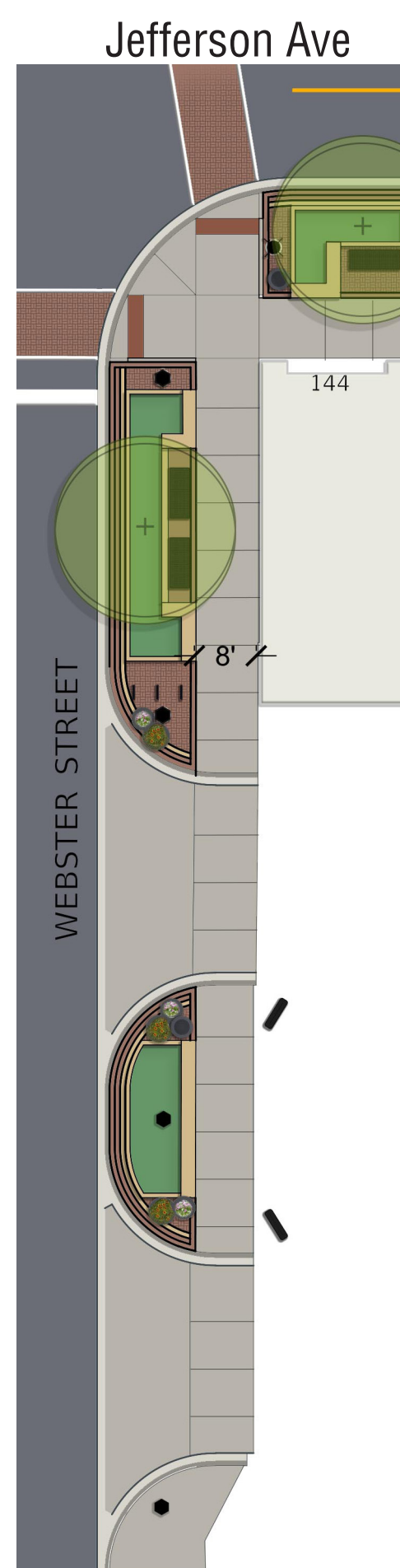

## Jackson Ave

Most Trees	Most Parking	Widest Sidewalk
Trees 1 Sidewalk Width 6' min Planter Area 80 SF	Trees 0 Sidewalk Width 8' min Planter Area 0 SF	Trees 1 Sidewalk Width 8' min Planter Area 125 SF

Main St

JACKSON AVENUE

Main St

JACKSON AVENUE

Main St

JACKSON AVENUE



# Sections of Alternates

**Jefferson Ave. - Looking West**  
Existing Conditions

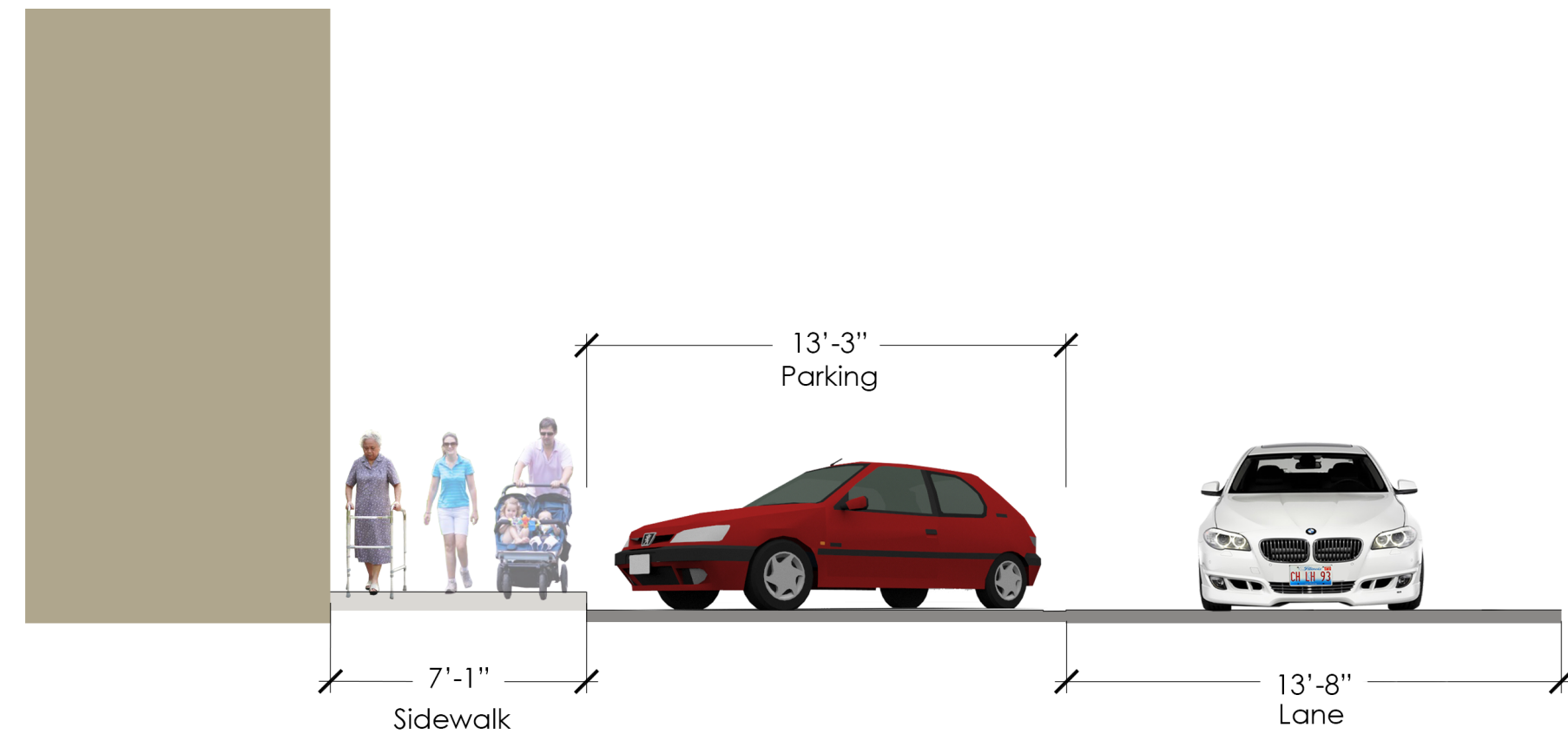

**Main St. - Looking North**  
Existing Conditions

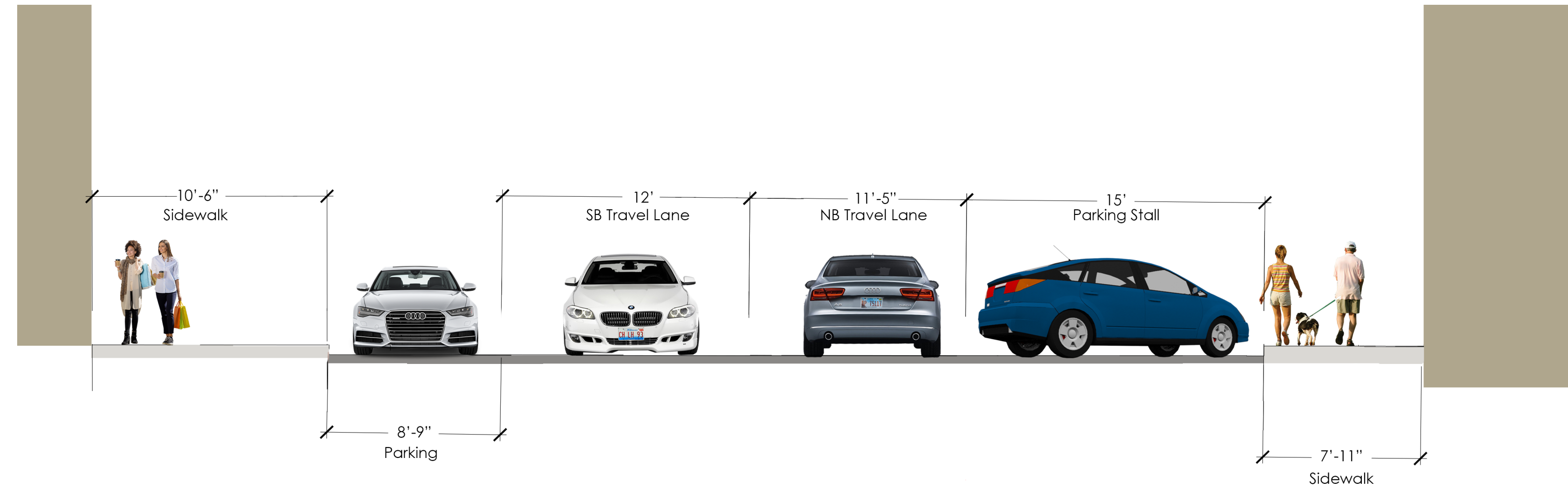

**Alternates A / B**

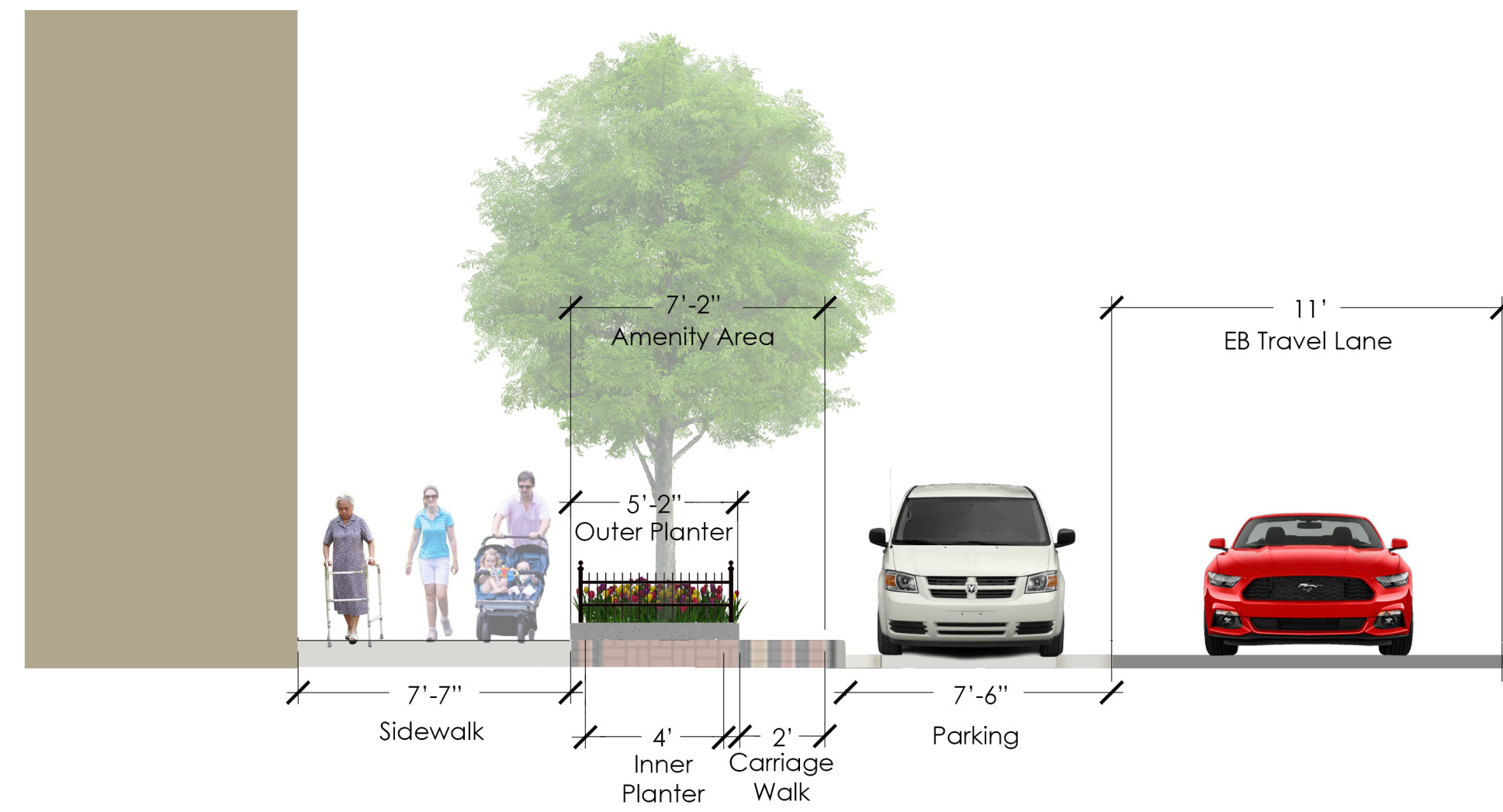

**Alternates A / B**

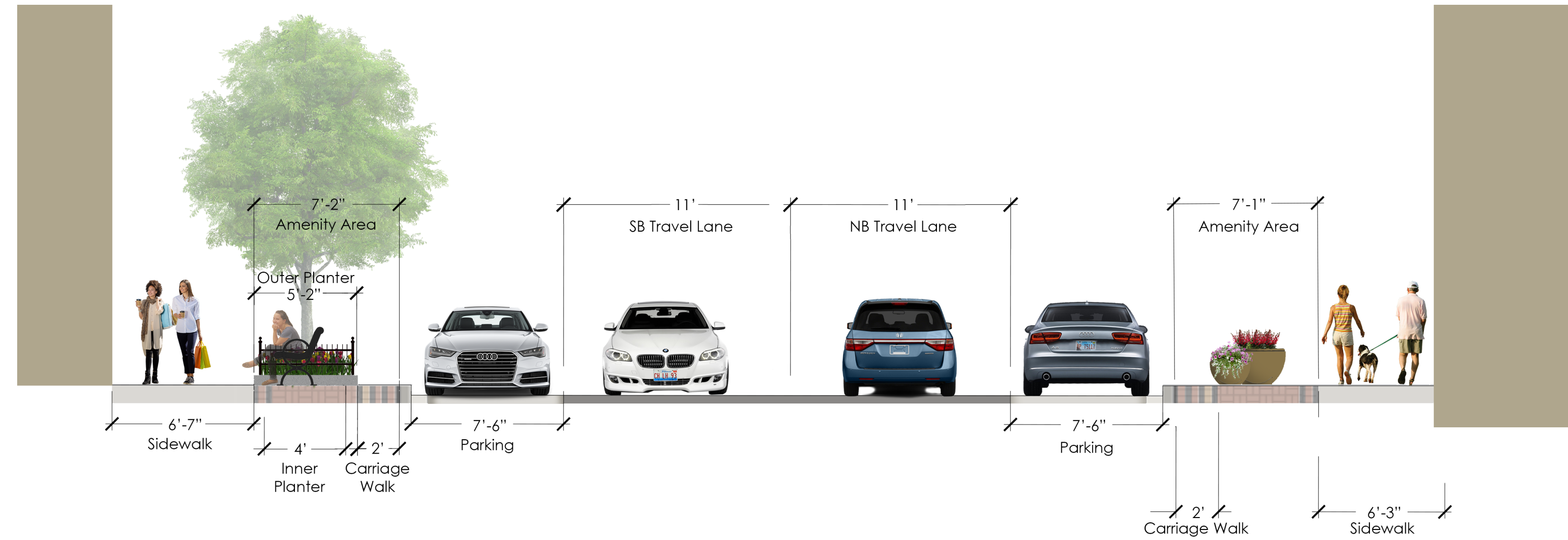

**Alternate C**

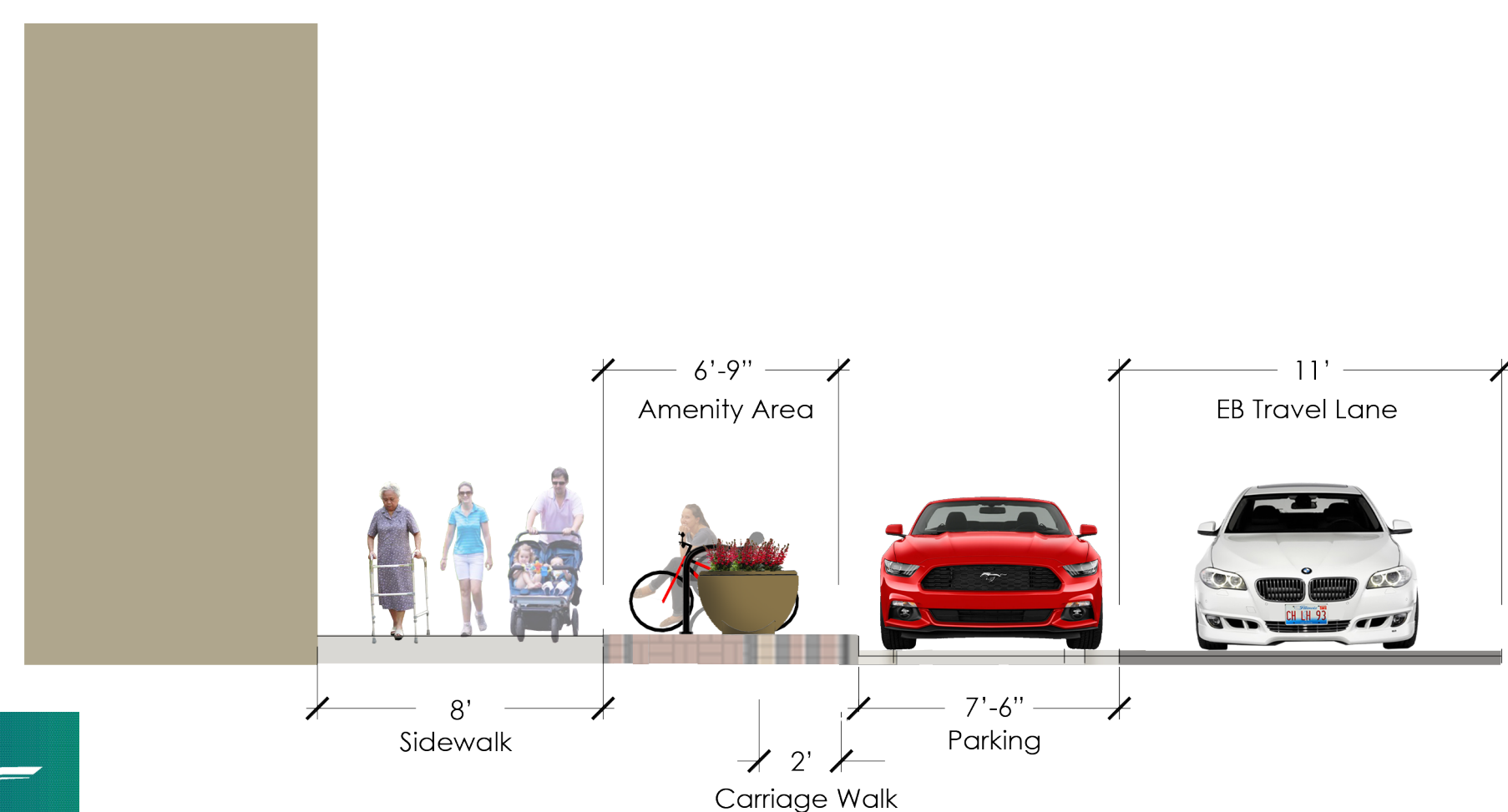

**Alternate C**

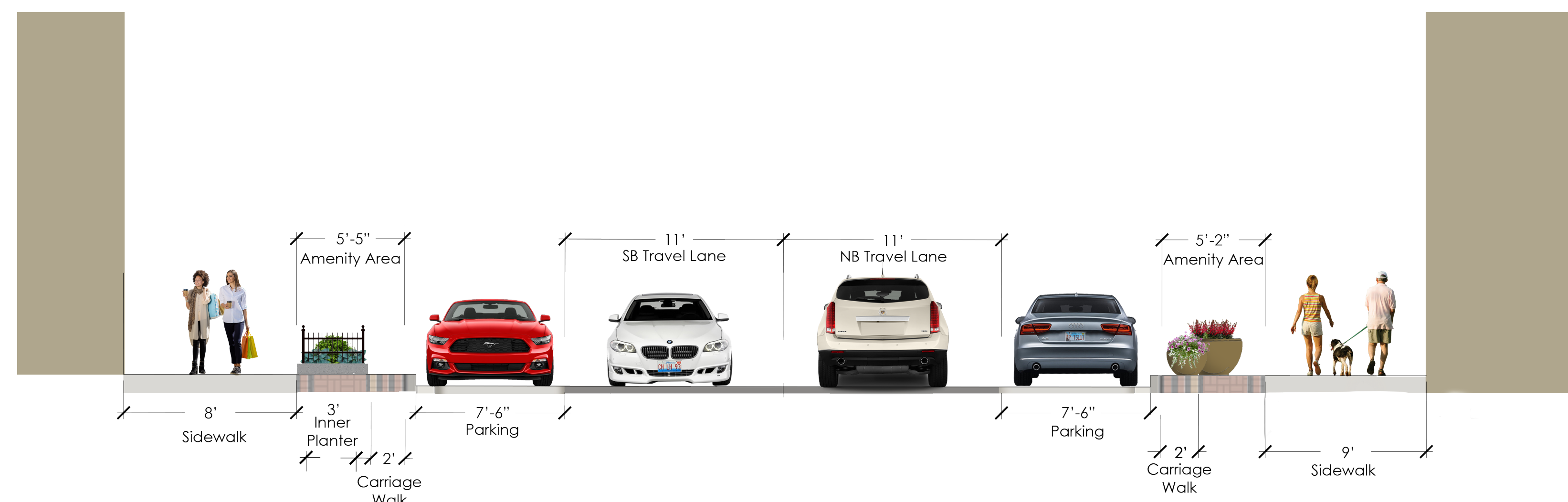







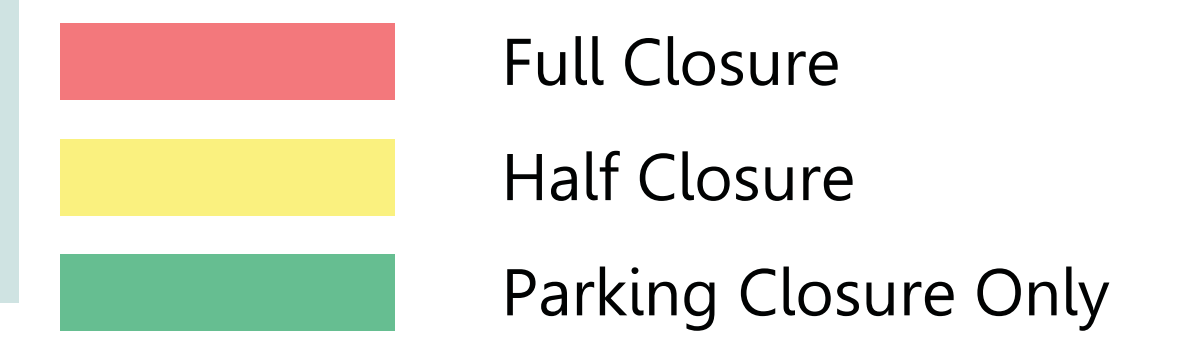

## Stage 1 - Main Street

**April 2020 - July 2020\***



1. Close & Detour Main Street
2. Close Parking on Main Street (Up to 22 Spaces)
3. Reconstruct Main Street Utilities - New Water Main, Water and Sewer Connections, New Storm Sewer
4. Reconstruct Main Street Roadway Pavement
5. Construct Main Street Streetscape - Sidewalk, Driveways, Light Poles, Planters, Etc.

## Stage 2 - Jefferson Avenue

**August 2020 - September 2020\***



1. Close & Detour Eastbound Jefferson Avenue
2. Close Parking on Jefferson Avenue (Up to 34 Spaces)
3. Reconstruct Jefferson Avenue Utilities - New Sewer Connections, New Storm Sewer
4. Reconstruct South Half of Jefferson Avenue Roadway Pavement
5. Construct Jefferson Avenue Streetscape - Sidewalk, Light Poles, Planters, Etc.

## Stage 3 - Jackson & Webster

**September 2020 - October 2020\***



1. Temporarily Close On-Street Parking on North Side of Jefferson Avenue, North Side of Jackson Avenue, and East Side of Webster Street (Up to 20 Spaces)
2. Rehab Existing Water Main on Jefferson, Webster, and Jackson, New Water Connections. Small Excavation Areas May Require Short-Term Detours or Lane Shifts.
3. Construct Webster Avenue and Jackson Avenue Streetscape - Sidewalk, Driveways, Light Poles, Planters, Etc.



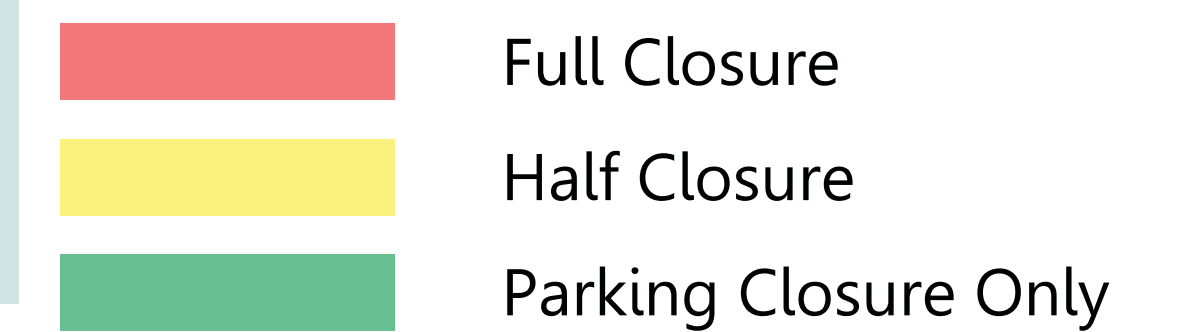

## Stage 1 - Main & Jefferson

**April 2020 - July 2020\***



1. Close & Detour Main Street and Eastbound Jefferson Avenue
2. Close Parking on Main Street and Jefferson Avenue (Up to 56 Spaces)
3. Reconstruct Main Street and Jefferson Avenue Utilities - New Water Main on Main St, Rehab Water Main on Jefferson Ave, New Water and Sewer Connections, New Storm Sewer
4. Reconstruct Main Street and South Half of Jefferson Avenue Roadway Pavement
5. Construct Main Street and Jefferson Avenue Streetscape - Sidewalk, Driveways, Light Poles, Planters, Etc.

## Stage 2 - Jackson & Webster

**August 2020 - September 2020 \***

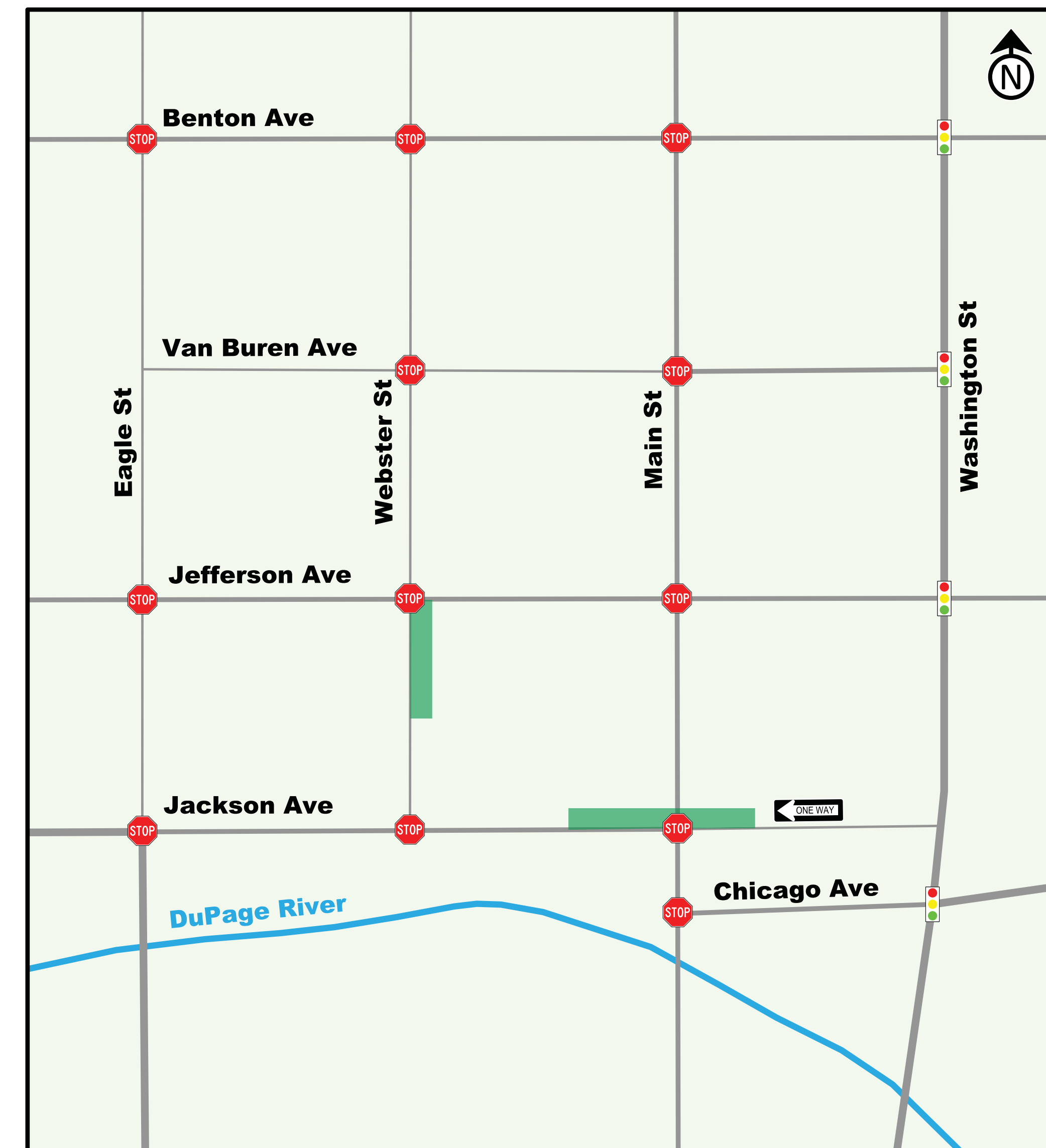

1. Temporarily Close On-Street Parking on North Side of Jackson Avenue, and East Side of Webster Street (Up to 20 Spaces)
2. Rehab Existing Water Main on Webster and Jackson, New Water Connections. Small Excavation Areas May Require Short-Term Detours or Lane Shifts.
3. Construct Webster Avenue and Jackson Avenue Streetscape - Sidewalk, Driveways, Light Poles, Planters, Etc.

**\*Dates estimated based on improvements as proposed and as weather permits**



# Naperville Downtown Streetscape Construction Staging - Alternative 3

**Work Zone Legend**

- Full Closure
- Half Closure
- Parking Closure Only

## Stage 1 - Underground Utilities

**April 2020 - June 2020\***

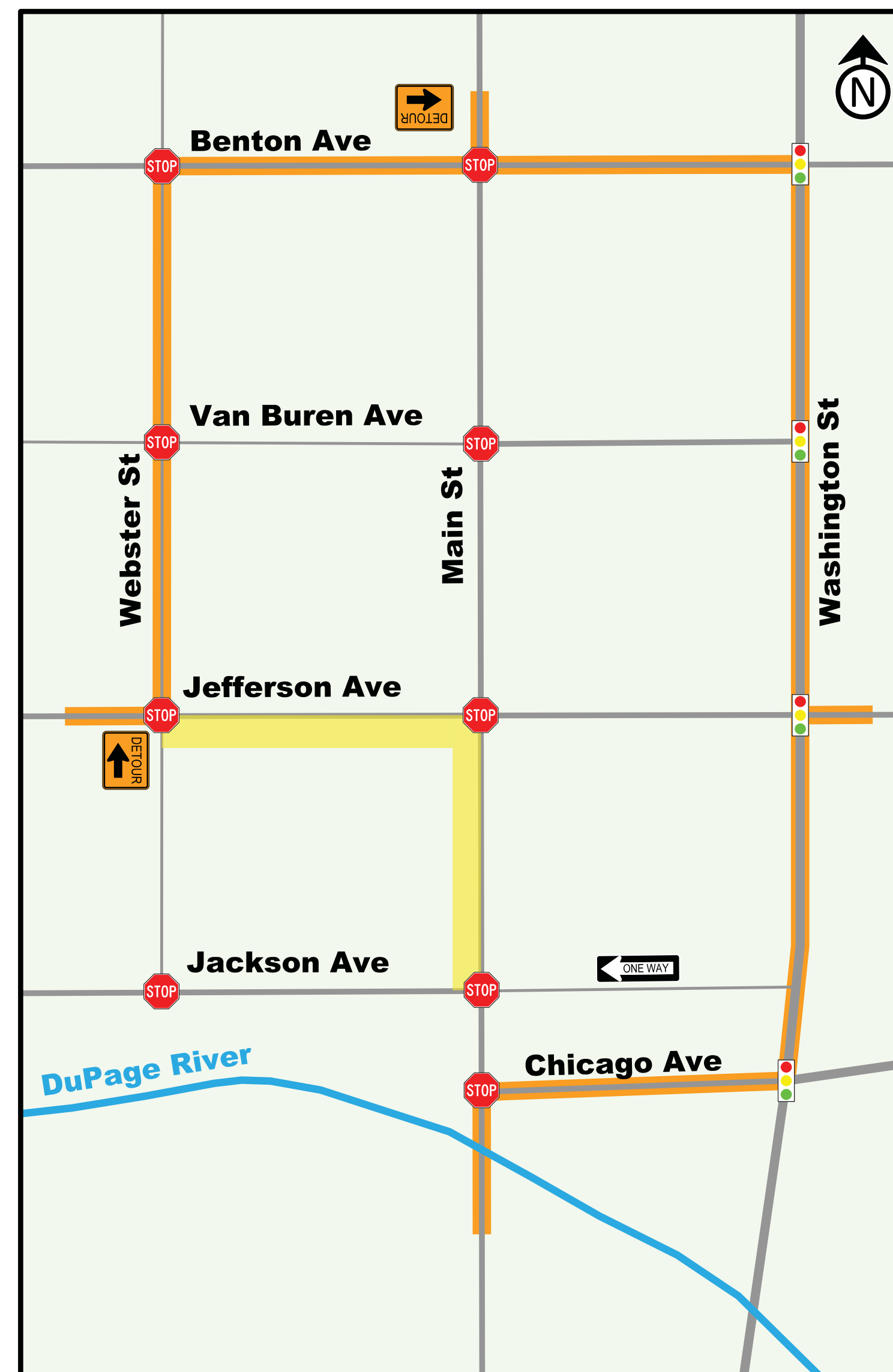

1. Close & Detour Southbound Main Street and Eastbound Jefferson Avenue
2. Close Parking on Main Street and Jefferson Avenue (Up to 56 Spaces)
3. Reconstruct Main Street and Jefferson Avenue Utilities - New Water Main on Main St, New Water and Sewer Connections, New Storm Sewer
4. Patch Trenches with Temporary Asphalt

## Stage 2 - Main & Jefferson (Half)

**July 2020 - August 2020\***

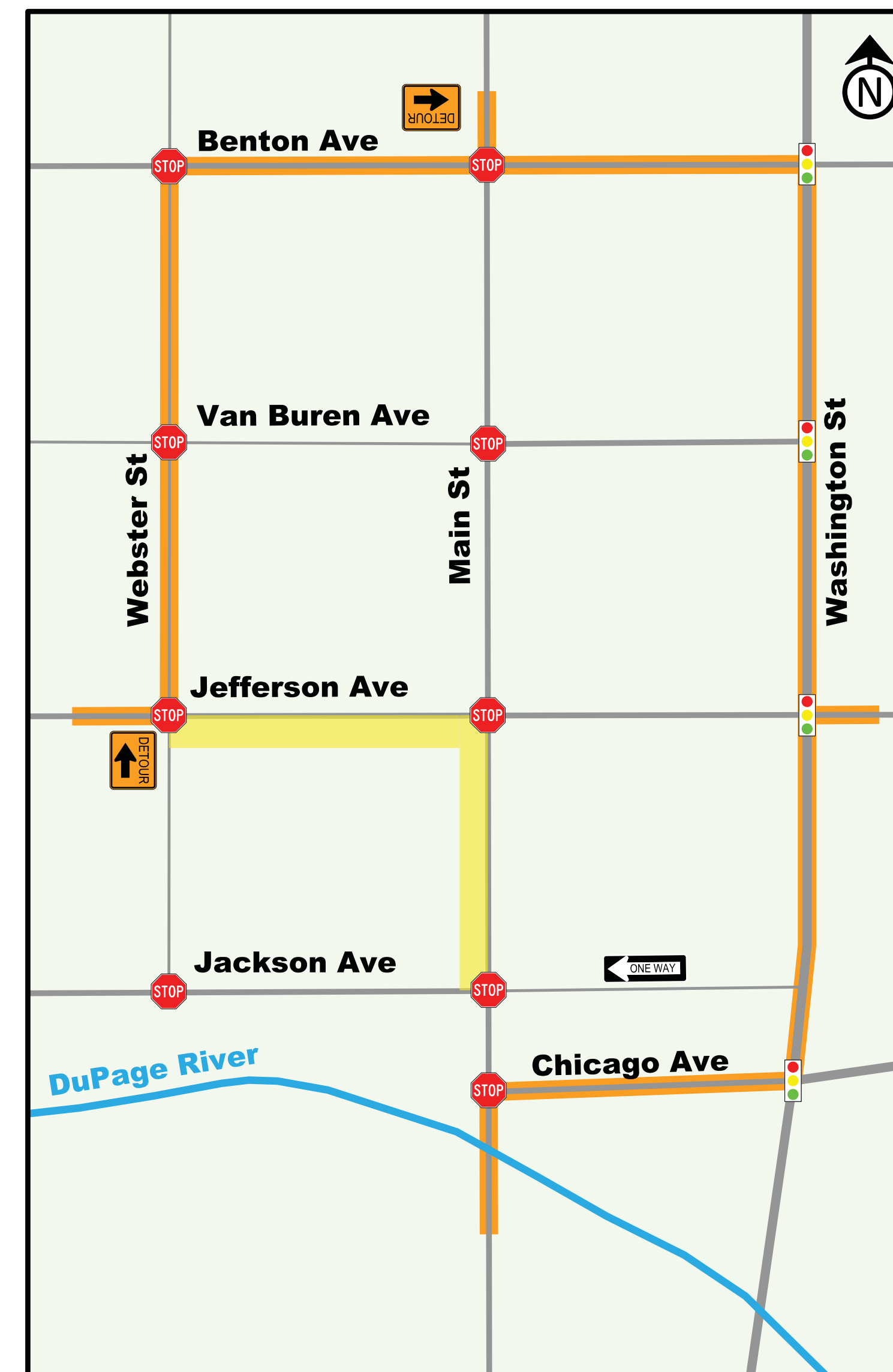

1. Maintain Southbound Main Street and Eastbound Jefferson Avenue Closure & Detour
2. Maintain Parking Closure on Main Street and Jefferson Avenue (Up to 56 Spaces)
3. Reconstruct West Half of Main Street and South Half of Jefferson Avenue Roadway Pavement
4. Construct West Half of Main Street and South Half of Jefferson Avenue Streetscape - Sidewalk, Driveways, Light Poles, Planters, Etc.

## Stage 3 - Main (Half)

**Sept. 2020 - Oct. 2020\***

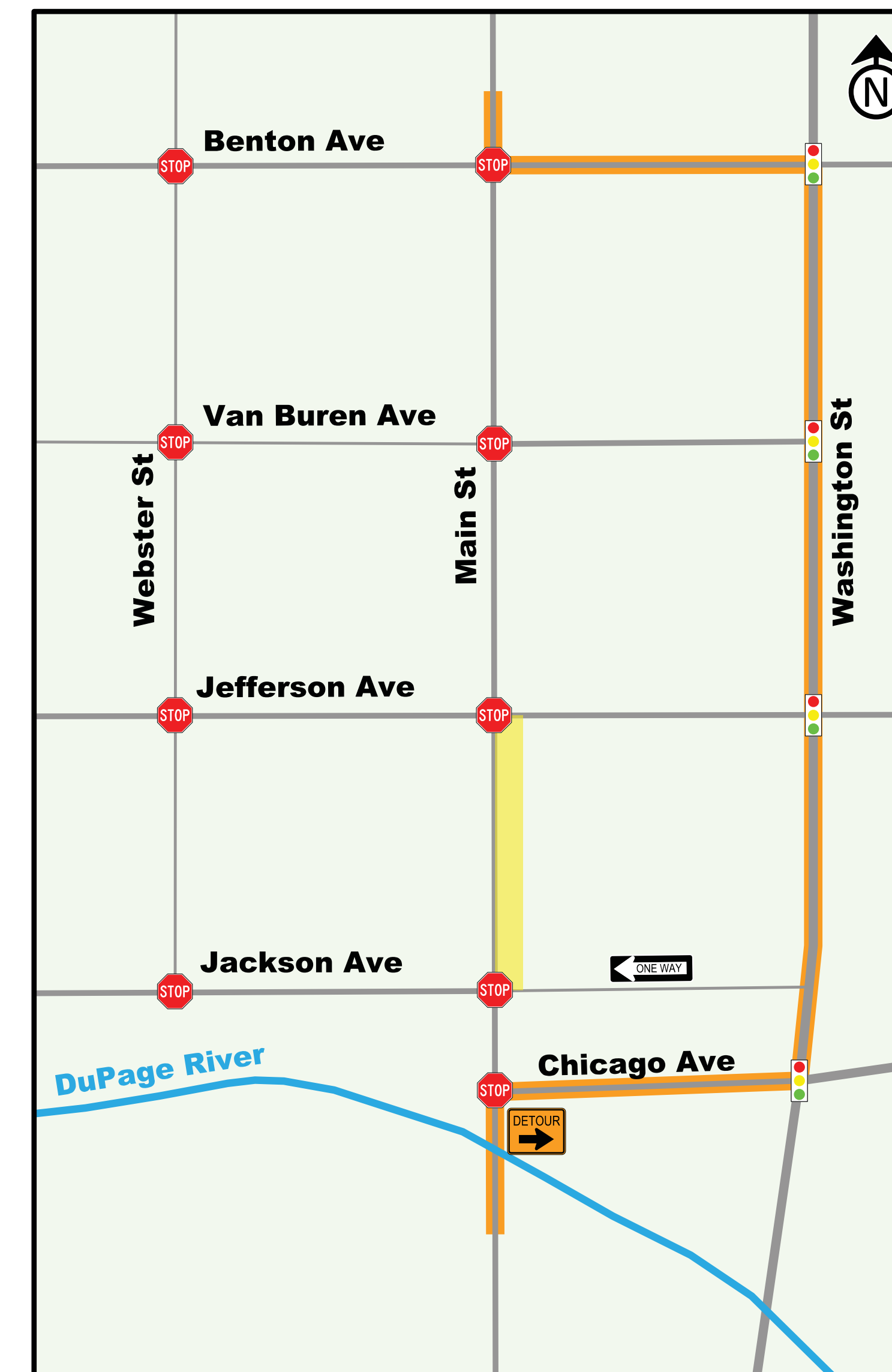

1. Close & Detour Northbound Main Street
2. Maintain Parking Closure on Main Street (Up to 22 Spaces)
3. Reconstruct East Half of Main Street Roadway Pavement
4. Construct East Half of Main Street Streetscape - Sidewalk, Driveways, Light Poles, Planters, Etc.

## Stage 4 - Jackson & Webster

**Nov. 2020 - Dec. 2020\***



1. Temporarily Close Parking on North Side of Jefferson, North Side of Jackson, and East Side of Webster (Up to 20 Spaces)
2. Rehab Water Main on Jefferson, Webster, and Jackson, New Water Connections. Small Excavation Areas May Require Short-Term Detours or Lane Shifts.
3. Construct Webster and Jackson Streetscape - Sidewalk, Driveways, Light Poles, Planters, Etc.



# Naperville Downtown Streetscape Construction Staging Alternatives

## Potential Detour Routes

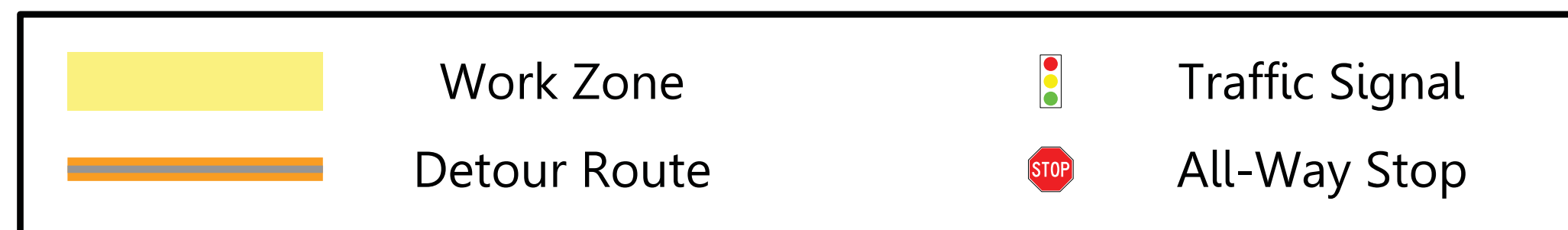

## All Alternatives

- Coordinated Pedestrian & ADA Accessibility
- Continuous Emergency Vehicle Access
- Temporarily Closed On-Street Parking

## Pros

## Cons

### Alternative 1

1. Close Main St THEN
2. Close Eastbound Jefferson Ave

Shorter Duration,  
Separated Detours

Full Road Closure

### Alternative 2

- Close Main St and Eastbound Jefferson Ave At The Same Time

Shortest Duration

Full Road Closure,  
Simultaneous  
Detours

### Alternative 3

1. Close Southbound Main St and Eastbound Jefferson Ave THEN
2. Close Northbound Main St

No Full Road  
Closures

Longest Duration,  
Potentially Two  
Construction  
Seasons

## Pedestrian Accommodations

